

ZEBRA systems F1 : Bjälklagsförstyvning 1

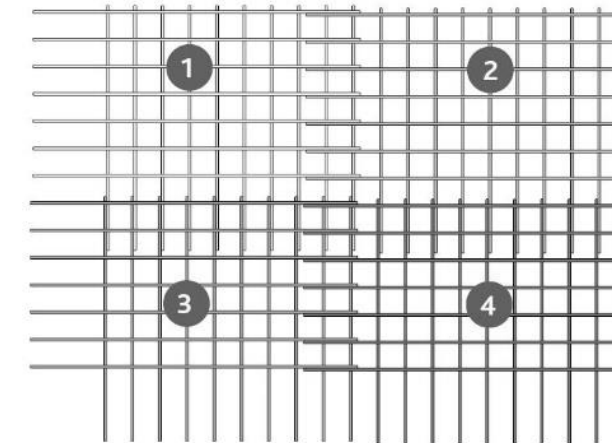
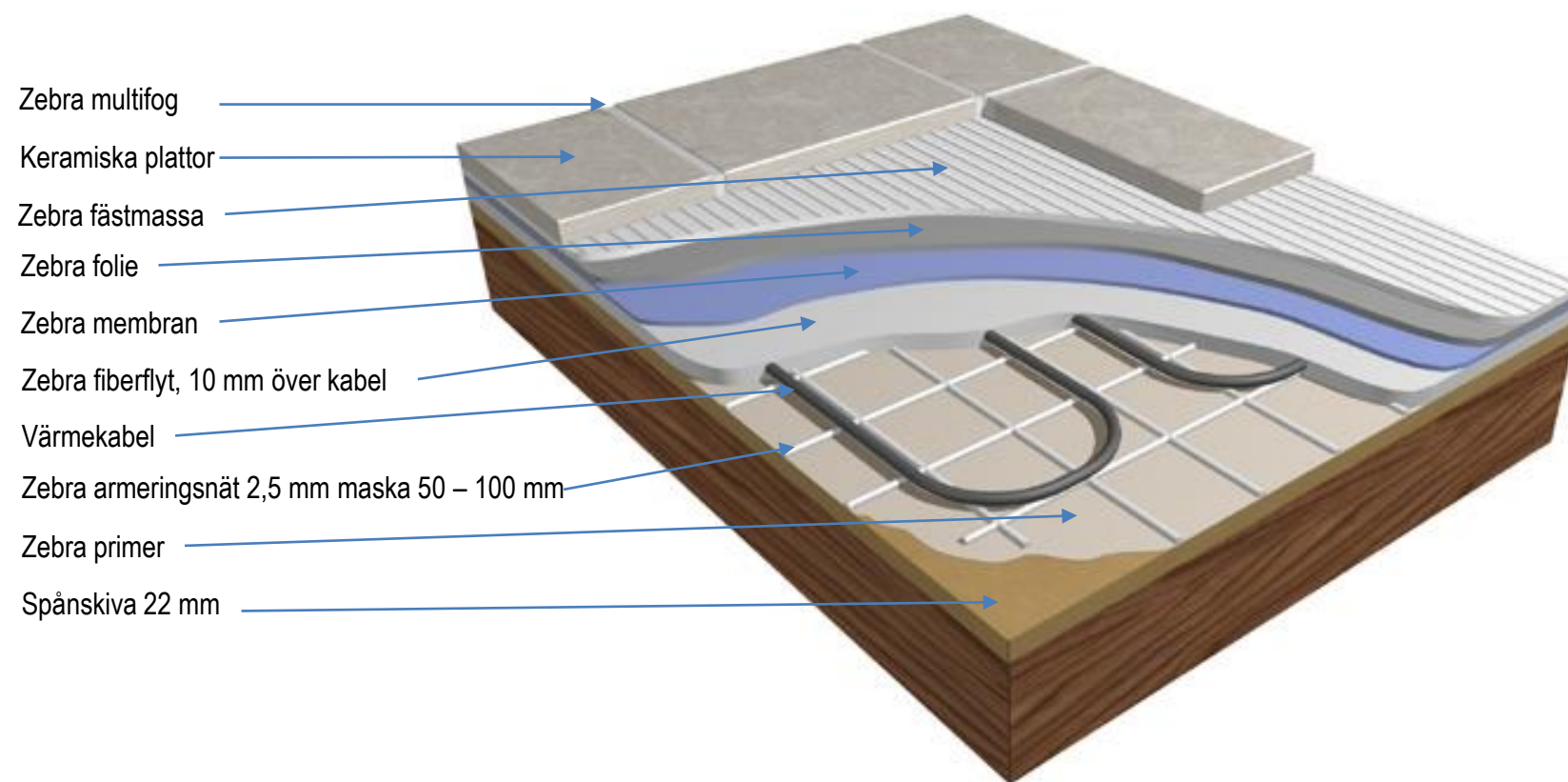

Armeringsnät skall överlappas

ZEBRA systems F1 : Bjälklagsförstyvning 2

Rotnät 2,5mm punktsvetsat
Rutmaska 70x70mm

Zebra primer

Zebra fiberflyt
minimum 20 mm

45x45 limmade och
skrivade

Plastfolie 0,5-0,7mm

45x220 K24

Lättfyllnadsmassa
EPS

Plyfa 12mm

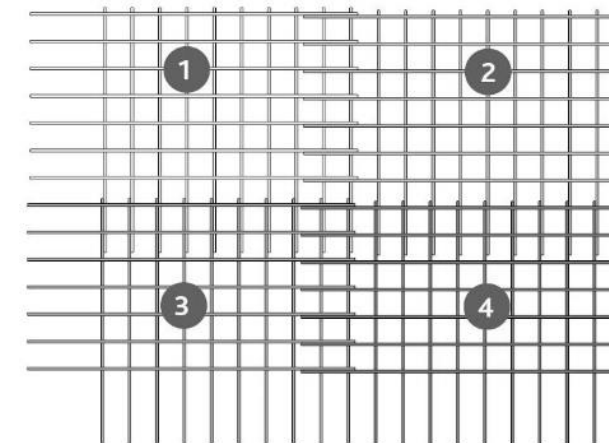
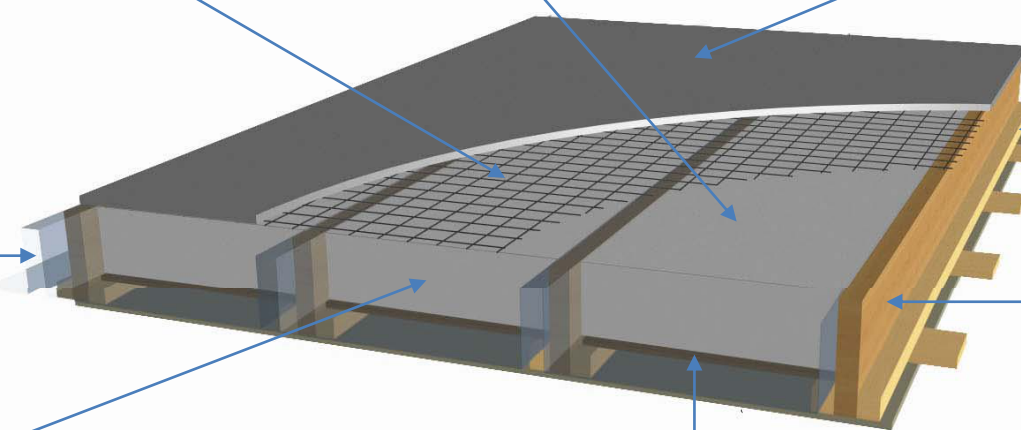

Armeringsnät skall överlappas

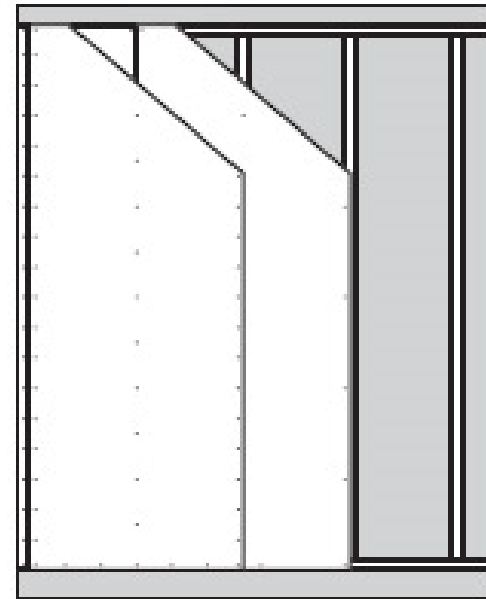
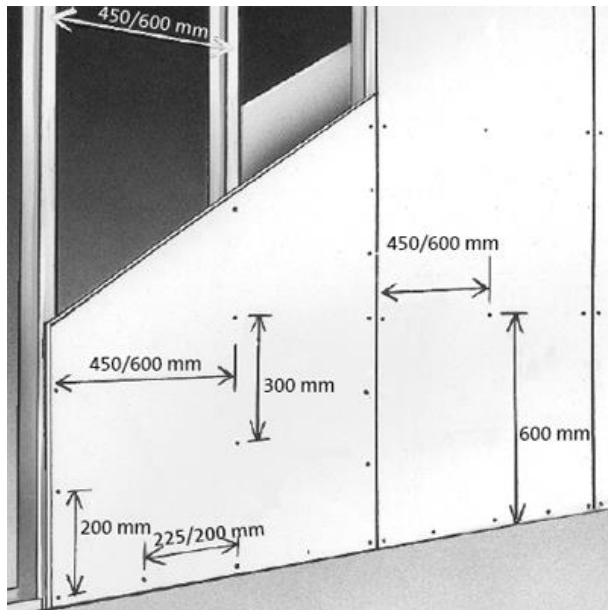

CC 600 dubbel gips

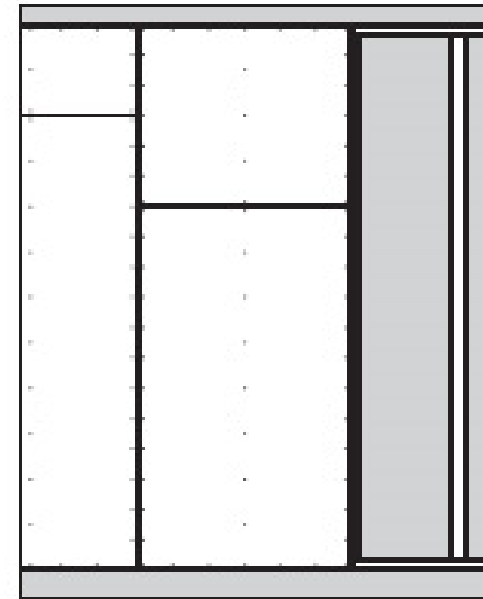

CC 450 enkel gipsskiva

